

Thioflex One

constructive solutions

One part polysulphide sealant

Uses

Thioflex One is ideal for sealing joints in window and door frame surrounds and as a capping for beaded glazing systems. It can also be used for sealing joints in external walls and cladding.

Advantages

Thioflex One is a one part polysulphide joint sealant which, on exposure to atmospheric moisture, cures to form a flexible rubber seal.

- One part gun application
- Cures to a tough, flexible rubbery seal
- Available in a range of colours
- Bonds to most building construction materials

Standards compliance

British Standard BS 5215: 1986.

Description

Thioflex One is a one part, gun applied, moisture activated, polysulphide sealant. After application a skin forms rapidly leaving the body of the sealant to cure more gradually, the rate being dependent upon temperature, humidity and dimensions of seal.

During the curing period, one part polysulphide sealants will accept limited movement normally associated with the applications described. For joints where significant early cyclic movements can be anticipated, Thioflex 600, a faster chemically cured, two part polysulphide sealant or Nitoseal MS50 should be used.

Technical support

Fosroc offers a comprehensive range of high performance, high quality technical products. In addition, Fosroc offers a technical support package to specifiers and contractors which includes computer-aided design (CAD), standard details as well as on-site technical advice from staff with unrivalled experience in the industry.

Design criteria

Thioflex One may be applied in joints ranging from 5 to 25 mm wide. The minimum depth should be 5 mm (10 mm on porous surfaces) and the maximum depth should not exceed 15 mm. The joint should also include a suitable back-up strip.

To ensure that the sealant remains within its stated movement capacity, the width of the designed sealing slot should be in accordance with the recommendations of BS 6093.

All surfaces require the use of a primer. Primer 4 for non-porous surfaces and Primer 7 for porous surfaces.

Example of an external wall joint

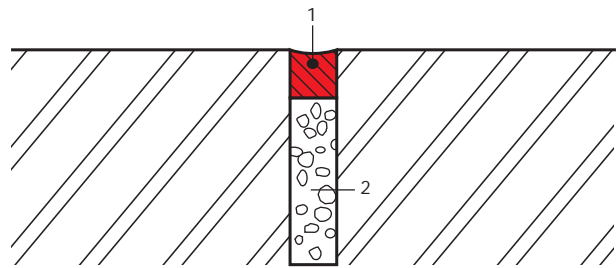

- 1 **Thioflex One**
- 2 ***Expandaf foam/Hydrocell**

Example of a sealed window frame

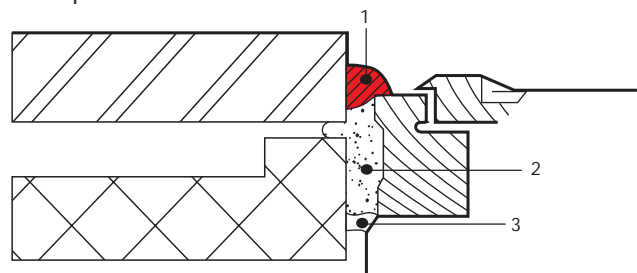

- 1 **Thioflex One**
 - 2 ***Secofoam**
 - 3 ***Decofill**
- *also available from Fosroc